

CERTIFICATE OF LOCATION OF GOVERNMENT CORNER

EAST QUARTER Corner of Section 16, Township 107N, Range 39W

5th Principal Meridian, State of Minnesota, County of MURRAY

At the corner location shown on the sketch:

On 8/27/2020 found a NO. 5 REBAR WITHOUT CAP, BENT, SHOT AT BASE

left monument as found lowered monument removed monument (explain)

On _____ placed a _____

SKETCH OF REFERENCE TIES

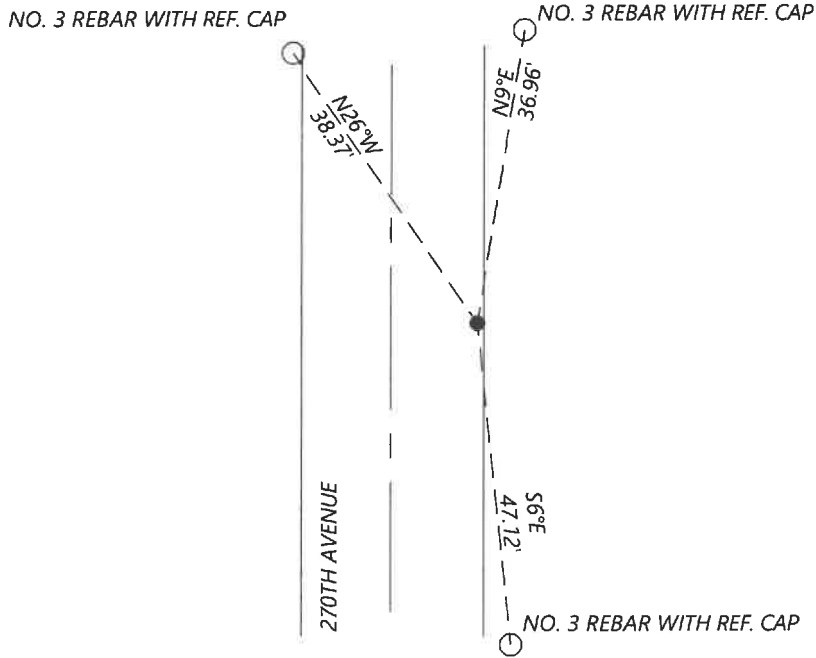

N.T.S.

Statement of evidence for this corner location is on back of this page.

I hereby certify that this document was researched and prepared by me or under my direct supervision and that I am a licensed Land Surveyor under the laws of the State of Minnesota.

Signature [Handwritten Signature]

Date 6/16/2021 License No. 45874

Title:

- Land Surveyor
- Professional Engineer
- County Surveyor
- County Engineer

OFFICE OF THE COUNTY RECORDER

County of Murray

I hereby certify that this document was filed in the Co.

Recorder's office at _____ M. on the _____ day of _____ A.D. 20

County Recorder Karen Brown

by JUN 22 2021, Deputy

DOCUMENT NO. _____

Statement of Evidence:

East Quarter Corner of Section 16, Township 107 North, Range 39 West, 5th Principal Meridian, Murray County, Minnesota.

No GLO Notes:

2013 December, Corner certificate by Perry Zieske for corners in Section 16 shows that he dug with a backhoe and found no corner evidence. He set a $\frac{5}{8}$ " iron stake with cap LS 23008 midway and on-line. Coordinates listed as: N: 181996.09 E: 564135.69

2020 September, Westwood Professional Services searched and found a No. 5 rebar at the corner. The coordinates fit with the 2013 corner certificate. I accepted the found monument and set reference ties.

Analysis of the recovered data, field evidence and survey measurements, indicates that the monument found is the correct perpetuation of this corner. For additional information concerning this corner please contact Westwood Professional Services.